

DK

Udskiftning af kartouche

Luk for vandet!

1. Skru pinden af grebet
1. Skru pinolskrue ud
1. Løft grebet af
2. Løsn designkappe
3. Løsn møtrik
4. Udskift kartouche

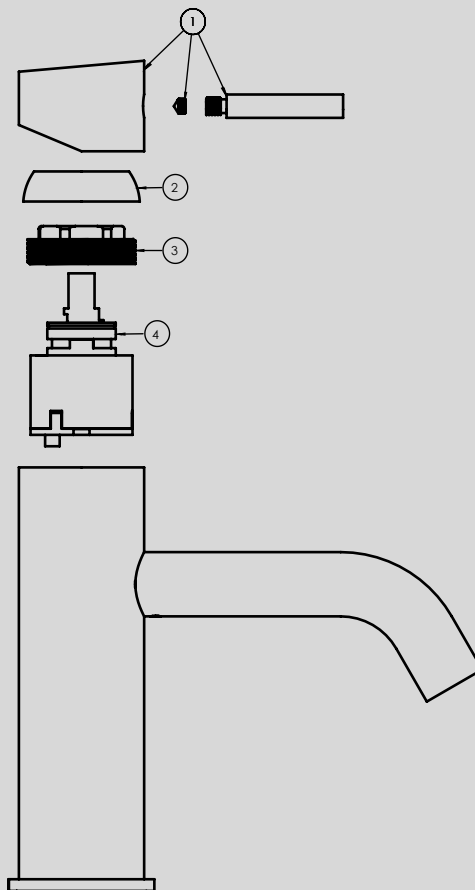

ENG

Replacement of cartridge

Shut off the water!

1. Unscrew the pin from the handle
1. Remove the set screw
1. Lift off the handle
2. Loosen the design cap
3. Loosen the nut
4. Replace the cartridge