

Grab rail f/ barrier-free

Knud Holscher collection

Product Ø32mm, 650mm, w/75mm snap-on cover rose.

Tender text Knud Holscher collection, grab rail 32 straight, 650mm,w/Ø75mm snap-on cover rose.
Manufactured in the highest quality marine grade, AISI 316 stainless steel, protecting against high levels of corrosion. 20-year warranty.

Product specification Dimensions: 726x76x85mm
Diameter: Ø32mm
Material: stainless steel AISI 316
Surface finish: satin grain 320, crafted by hand
[20-year warranty \(5 years for coated items\)](#)

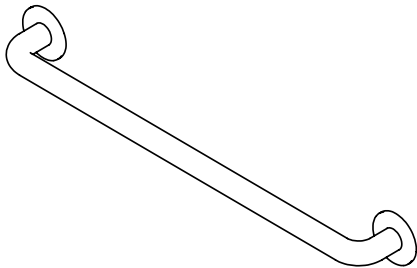
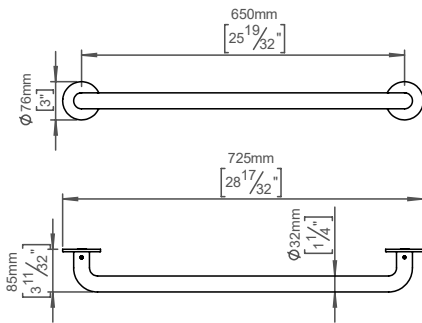

Available finishes

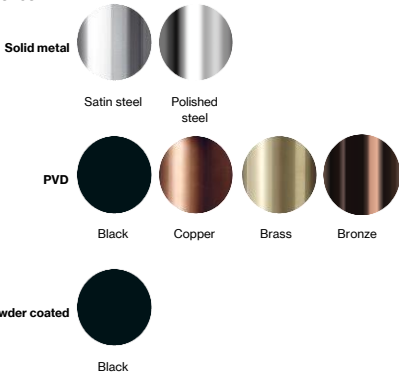

Spare parts/ accessories 14496302321 - Thrust rose only
14970100106 - Grub screw M6x8mm

Mounting <https://dline.com/mounting-instructions/>

Product care
d line products are produced in the highest quality marine grade AISI 316 stainless steel. To sustain the unique d line finish please follow the below instructions:
• Wash down the surfaces using soapy water or mild detergent
• Always thoroughly rinse off with clean water
• To complete the cleaning procedure dry/polish the surface with a soft dry cloth
Please do not use scouring powder, steel wool, chloride based detergents or other aggressive cleaning products as these may damage the surface.
If spots or corrosion appear on the surface it is not due to the stainless steel quality, but to impurities in the environment, aggressive conditions or improper or insufficient cleaning.