

Fat pull handle, small - brass

Item number 15900801070
Surface Polished

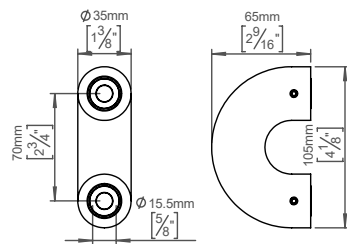

Tom Dixon collection

Product Bush, Ø35mm, cc 70mm, brass

Tender text FAT pull handle, small. Bush, Ø35mm, cc 70mm, polished. The FAT collection is a series of architectural hardware pieces designed by English industrial designer Tom Dixon. Material: brass. W: 105mmxH: 65mmxD: Ø35mm. 20-year warranty.

Product specification Dimensions: 105x65mm. Diameter: Ø35mm. Material: brass
Surface finish: polished brass, crafted by hand
[20-year warranty \(5 years for coated items\)](#)

Available finishes

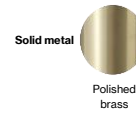

Spare parts/ accessories 14491792303 - Bush head bolt, M10x30mm
14970100077 - Grub screw, M5x10mm, DIN 916
14976500106 - Allen key, 2.5mm
14974102251 - Thrust rose, Ø26.4x2mm
12496500305 - Fittings for glass door, f/2 sides

Mounting <https://dline.com/mounting-instructions/>

8 pcs. per box

Product care

d line products are produced in the highest quality brass. To sustain the unique d line finish please follow the below instructions:

- Wash down the surfaces using soapy water or mild detergent
- Always thoroughly rinse off with clean water

• To complete the cleaning procedure dry/polish the surface with a soft dry cloth
Please do not use scouring powder, steel wool, chloride based detergents or other aggressive cleaning products as these may damage the surface.

If spots or corrosion appear on the surface it is not due to the stainless steel quality, but to impurities in the environment, aggressive conditions or improper or insufficient cleaning.