

# Lever handle U

## Base collection

**Product** Solid rose, cc 30mm, 33-59mm.

**Tender text** BASE collection, lever handle 16U pair, 8x8mm, solid rose, cc 30mm, 33-59 mm in satin finished AISI 304 stainless steel. Certified in accordance with EN 1906 to 47-B1140U. 10-year warranty.

**Product specification** Dimensions: 142x50x56mm  
 Diameter: Ø16mm  
 Material: stainless steel AISI 304  
 Surface finish: satin finished  
[10-year warranty](#)

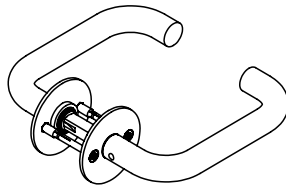
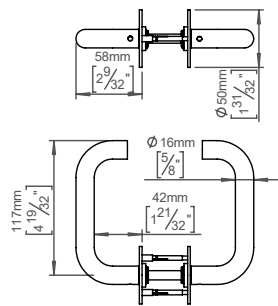

### Available finishes

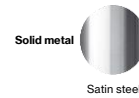

**Spare parts/ accessories**

- 14970102016 - Grub screw M5x6,8mm
- 14296174107 - Sectioned bolt set M4x110mm with bush
- 14281092092 - Spindle for door 33-59mm
- 14976700105 - TX10 tool kit

**Mounting** <https://dline.com/mounting-instructions/>

### Product care

d line products are produced in the highest quality AISI 304 stainless steel. To sustain the unique d line finish please follow the below instructions:

- Wash down the surfaces using soapy water or mild detergent
- Always thoroughly rinse off with clean water
- To complete the cleaning procedure dry/polish the surface with a soft dry cloth

Please do not use scouring powder, steel wool, chloride based detergents or other aggressive cleaning products as these may damage the surface.

If spots or corrosion appear on the surface it is not due to the stainless steel quality, but to impurities in the environment, aggressive conditions or improper or insufficient cleaning.