

# Fat pull handle, small - steel



## Tom Dixon collection

## Product

Bush, Ø35mm, cc 70mm, satin

## Tender text

FAT pull handle, small. Bush, Ø35mm, cc 70mm, satin finish. The FAT collection is a series of architectural hardware pieces designed by English industrial designer Tom Dixon. Manufactured in the highest quality marine grade, AISI 316 stainless steel, protecting against high levels of corrosion. W: 105mmxH: 65mmxD: Ø35mm. 20-year warranty.

## Product specification

Dimensions: 105x65mm. Diameter: Ø35mm. Material: stainless steel AISI 316. Surface finish: satin grain 320, crafted by hand [20-year warranty \(5 years for coated items\)](#)

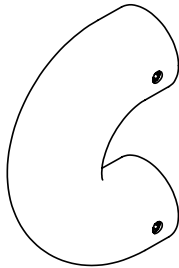
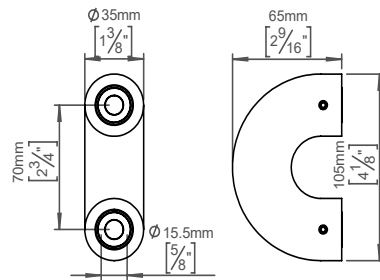

## Available finishes

Solid metal



Satin steel

PVD



Charcoal

Brass

Powder coated



Electric blue

## Spare parts/ accessories

14491792303 - Bush head bolt M10x30mm  
 14491792605 - Bush head bolt M10x60mm  
 14970100077 - Grub screw M5x10mm, DIN 916  
 14976500106 - Allen key 2.5mm  
 14974102251 - Thrust rose Ø26.4x2mm  
 12496500304 - Fitting f/glass door Ø10mm

## Mounting

<https://dline.com/mounting-instructions/>

8 pcs. per box

## Product care

d line products are produced in the highest quality marine grade AISI 316 stainless steel. To sustain the unique d line finish please follow the below instructions:

- Wash down the surfaces using soapy water or mild detergent
  - Always thoroughly rinse off with clean water
  - To complete the cleaning procedure dry/polish the surface with a soft dry cloth
- Please do not use scouring powder, steel wool, chloride based detergents or other aggressive cleaning products as these may damage the surface.
- If spots or corrosion appear on the surface it is not due to the stainless steel quality, but to impurities in the environment, aggressive conditions or improper or insufficient cleaning.