

Spout 190 mm

Qtoo collection

Product 190mm projection, Ø90mm, satin finish.

Tender text QTOO collection, spout, 7 15/32"-190mm, projection, rose diameter 3 1/2"-90mm. Manufactured in the highest quality marine grade, AISI 316 stainless steel, protecting against high levels of corrosion. 20 year warranty.

Product specification Spout projection: 190mm - 7 15/32"
 Fixed spout
 Spout diameter: Ø22mm - 7/8"
 Built in aerator
 Rose diameter: Ø90mm - 3 1/2"
 1/2" connection
 Max. Water flow rate: 5L - 1,3gpm
 Spare flow aerator included
 Lead free compliant
 Material: Marine grade AISI 316 stainless steel
[20-year warranty \(5 years for coated items\)](#)

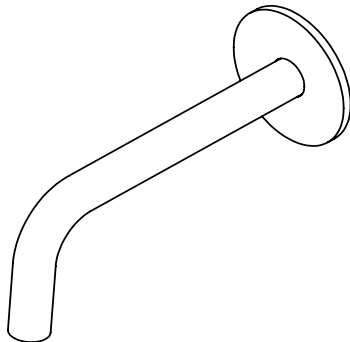
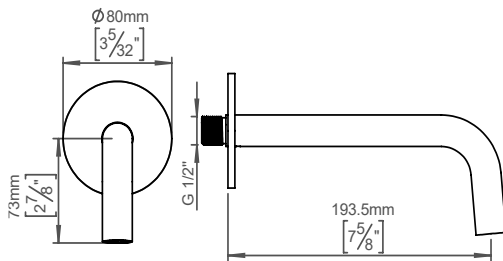

Available finishes

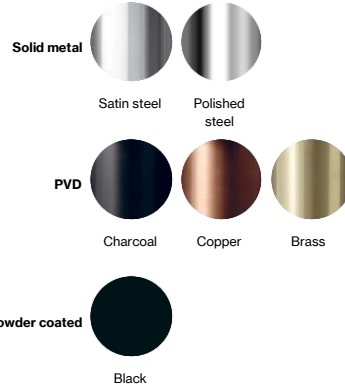

Spare parts/ accessories

Mounting <https://dline.com/mounting-instructions/>

Product care

d line products are produced in the highest quality marine grade AISI 316 stainless steel. To sustain the unique d line finish please follow the below instructions:

- Wash down the surfaces using soapy water or mild detergent
- Always thoroughly rinse off with clean water
- To complete the cleaning procedure dry/polish the surface with a soft dry cloth

Please do not use scouring powder, steel wool, chloride based detergents or other aggressive cleaning products as these may damage the surface.

If spots or corrosion appear on the surface it is not due to the stainless steel quality, but to impurities in the environment, aggressive conditions or improper or insufficient cleaning.