

Shower arm f/ ceiling 100 mm

QS5209M

Satin finish

Qtoo collection

Product 100mm, Ø90mm, satin finish.

Tender text QTOO collection, shower arm for ceiling, length 3 15/16"-100mm. Manufactured in the highest quality marine grade, AISI 316 stainless steel, protecting against high levels of corrosion. 20 year warranty.

Product specification Arm projection: 100mm - 3 15/16"
1/2" connection
Rose diameter: Ø90mm - 3 1/2"
Material: Marine grade AISI 316 stainless steel
Lead free compliant
[20-year warranty \(5 years for coated items\)](#)

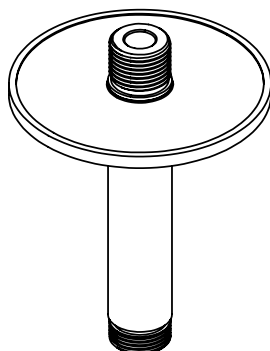
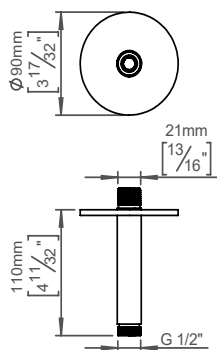

Available finishes

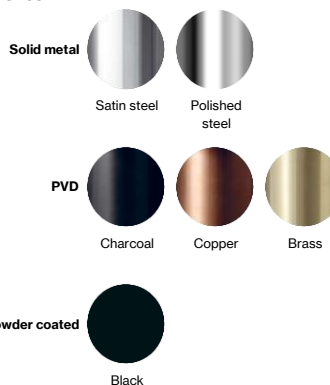

Spare parts/ accessories

Mounting <https://dline.com/mounting-instructions/>

Product care

d line products are produced in the highest quality marine grade AISI 316 stainless steel. To sustain the unique d line finish please follow the below instructions:

- Wash down the surfaces using soapy water or mild detergent
 - Always thoroughly rinse off with clean water
 - To complete the cleaning procedure dry/polish the surface with a soft dry cloth
- Please do not use scouring powder, steel wool, chloride based detergents or other aggressive cleaning products as these may damage the surface.
- If spots or corrosion appear on the surface it is not due to the stainless steel quality, but to impurities in the environment, aggressive conditions or improper or insufficient cleaning.