

Two-way shower w/ thermostat

Item number **Surface**
 QS3300-340WMP2 Satin finished



Qtoo collection

Product 400mm projection, Ø90mm, satin copper.

Tender text QTOO collection, complete built in two-way thermostat shower. Manufactured in the highest quality marine grade, AISI 316 stainless steel, protecting against high levels of corrosion. 20 year warranty.

Product specification Build in depth: 69mm (2 3/4")
 Projection: 400mm (16 3/16")
 Rose diameter: Ø90mm (3 1/2")
 Head shower: Ø300mm (11 13/16")
 Head shower: preinstalled flow regulator 5,7 l/min (1,5 gpm)
 Hand shower: preinstalled flow regulator 9,5 l/min (2,5 gpm)
 (contact sellers for other regulator options)
 Lead free compliant
 Anti-limescale function on head and hand shower
 Material: Marine grade AISI 316 stainless steel
[20-year warranty \(5 years for coated items\)](#)

Available finishes

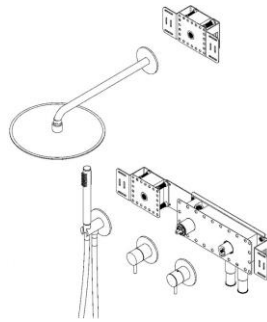
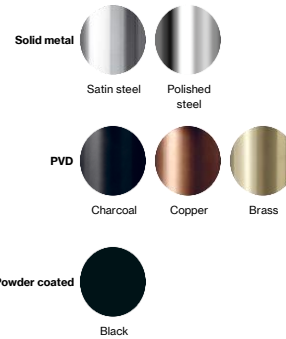

Spare parts/ accessories

Mounting <https://dline.com/mounting-instructions/>

Product care

d line products are produced in the highest quality marine grade AISI 316 stainless steel. To sustain the unique d line finish please follow the below instructions:

- Wash down the surfaces using soapy water or mild detergent
- Always thoroughly rinse off with clean water
- To complete the cleaning procedure dry/polish the surface with a soft dry cloth

Please do not use scouring powder, steel wool, chloride based detergents or other aggressive cleaning products as these may damage the surface.
 If spots or corrosion appear on the surface it is not due to the stainless steel quality, but to impurities in the environment, aggressive conditions or improper or insufficient cleaning.